

S-Camshafts:

BPW SERIES:

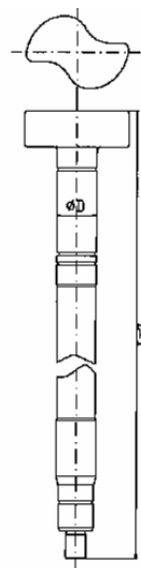

Original No.	DxL(mm)	Spline	Application
05.097.05.01.1/02.1	42x404	10	BPW
05.097.05.03.1/04.1	42x418	10	BPW
05.097.05.05.1/06.1	42x430	10	BPW
05.097.05.07.1/08.1	42x441	10	BPW
05.097.05.09.1/10.1	42x480	10	BPW
05.097.05.11.1/12.1	42x516	10	BPW
05.097.05.13.1/14.1	42x541	10	BPW
05.097.05.15.1/16.1	42x550	10	BPW
05.097.05.17.1/18.1	42x585	10	BPW
05.097.05.19.1/20.1	42x618	10	BPW
05.097.05.21.1/22.1	42x628	10	BPW
05.097.05.23.1/24.1	42x640	10	BPW
05.097.05.25.1/26.1	42x666	10	BPW
05.097.05.27.1/28.1	42x696	10	BPW
05.097.05.29.1/30.1	42x734	10	BPW
05.097.05.39.1/40.1	42x676	10	BPW
05.097.05.45.1/46.1	42x576	10	BPW
05.097.05.47.1/48.1	42x602	10	BPW
05.097.05.49.1/50.1	42x818	10	BPW

Original No.	DxL(mm)	Spline	Application
05.097.05.55.1/56.1	42x870	10	BPW
05.097.05.57.1/58.1	42x768	10	BPW
05.097.02.37.0/38.0	42x232	10	BPW
05.097.05.25.0/26.0	42x663	10	BPW
05.097.60.09.1/10.1	42x660	10	BPW
05.097.60.41.2/42.2	42x794	10	BPW
05.097.05.15.3/16.3	42x550	10	BPW
05.097.09.17.3/18.3	42x985	10	BPW
05.097.05.01.0/02.0	42x401	10	BPW
05.097.05.03.0/04.0	42x415	10	BPW
05.097.05.05.0/06.0	42x427	10	BPW
05.097.05.07.0/08.0	42x438	10	BPW
05.097.05.09.0/10.0	42x477	10	BPW
05.097.05.11.0/12.0	42x513	10	BPW
05.097.05.13.0/14.0	42x538	10	BPW
05.097.05.15.0/16.0	42x547	10	BPW
05.097.05.17.0/18.0	42x585	10	BPW
05.097.05.19.0/20.0	42x615	10	BPW
05.097.05.21.0/22.0	42x625	10	BPW
05.097.05.23.0/24.0	42x638	10	BPW
05.097.05.25.0/26.0	42x663	10	BPW
05.097.05.29.0/30.0	42x731	10	BPW
05.097.05.31.0/32.0	42x857	10	BPW
05.097.05.35.0/36.0	42x453	10	BPW
05.097.05.37.0/38.0	42x750	10	BPW
05.097.05.39.0/40.0	42x673	10	BPW
05.097.05.41.0/42.0	42x288	10	BPW
05.097.05.43.0/44.0	42x313	10	BPW
05.097.05.45.0/46.0	42x573	10	BPW
05.097.05.47.0/48.0	42x600	10	BPW
05.097.05.49.0/50.0	42x815	10	BPW
05.097.05.51.0/52.0	42x269	10	BPW
05.097.07.13.0/14.0	42x192	10	BPW
05.097.09.07.1/08.1	42x291	10	BPW
05.097.60.07.1/08.1	42x673	10	BPW
05.097.60.05.2/06.2	42x682	10	BPW
05.097.05.01.3/02.3	42x404	10	BPW
05.097.05.03.3/04.3	42x418	10	BPW

Original No.	DxL(mm)	Spline	Application
05.097.05.05.3/06.3	42x430	10	BPW
05.097.05.07.3/08.3	42x441	10	BPW
05.097.05.09.3/10.3	42x480	10	BPW
05.097.05.11.3/12.3	42x516	10	BPW
05.097.05.13.3/14.3	42x541	10	BPW
05.097.05.15.3/16.3	42x550	10	BPW
05.097.05.17.3/18.3	42x588	10	BPW
05.097.05.19.3/20.3	42x618	10	BPW
05.097.05.21.3/22.3	42x628	10	BPW
05.097.05.23.3/24.3	42x641	10	BPW
05.097.05.25.3/26.3	42x666	10	BPW
05.097.05.27.3/28.3	42x696	10	BPW
05.097.05.29.3/30.3	42x734	10	BPW
05.097.05.37.3/38.3	42x753	10	BPW
05.097.05.39.3/40.3	42x676	10	BPW
05.097.05.45.3/46.3	42x576	10	BPW
05.097.05.47.3/48.3	42x603	10	BPW
05.097.05.49.3/50.3	42x818	10	BPW
05.097.05.55.3/56.3	42x870	10	BPW
05.097.05.57.3/58.3	42x768	10	BPW
05.097.09.07.3/08.3	42x291	10	BPW
05.097.09.09.3/10.3	42x870	10	BPW
05.097.09.13.3/14.3	42x768	10	BPW
05.097.09.15.3/16.3	42x818	10	BPW
05.097.60.01.3/02.3	42x520/546	10	BPW
05.097.60.03.3/04.3	42x594/620	10	BPW
05.097.60.05.3/06.3	42x682/708	10	BPW
05.097.60.07.3/08.3	42x647/673	10	BPW
05.097.60.09.3/10.3	42x634/660	10	BPW
05.097.60.11.3/12.3	42x462/488	10	BPW
05.097.60.13.3/14.3	42x582/608	10	BPW
05.097.60.15.3/16.3	42x547/573	10	BPW
05.097.60.17.3/18.3	42x740/766	10	BPW
05.097.60.19.3/20.3	42x337/363	10	BPW
05.097.60.21.3/22.3	42x800/826	10	BPW
05.097.60.23.3/24.3	42x673/699	10	BPW
05.097.60.25.3/26.3	42x773/799	10	BPW
05.097.60.27.3/28.3	42x307/333	10	BPW

Original No.	DxL(mm)	Spline	Application
05.097.60.29.3/30.3	42x973/999	10	BPW
05.097.60.31.3/32.3	42x848/874	10	BPW
05.097.60.33.3/34.3	42x873/899	10	BPW
05.097.60.35.3/36.3	42x923/949	10	BPW
05.097.60.37.3/38.3	42x823/849	10	BPW
05.097.60.39.3/40.3	42x436/462	10	BPW
05.097.60.41.3/42.3	42x723/749	10	BPW
05.097.60.43.3/44.3	42x505/531	10	BPW
05.097.60.45.3/46.3	42x707/733	10	BPW
05.097.60.47.3/48.3	42x763/789	10	BPW
05.097.60.49.3/50.3	42x692/718	10	BPW

ROR SERIES:

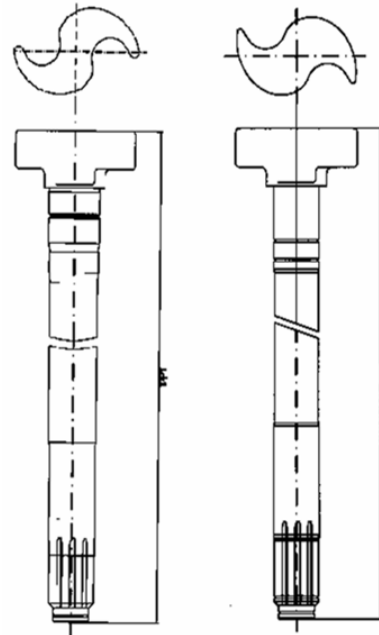

Original No.	DxL(mm)	Spline	Application
212 19 257/258	42x572	10	ROR
212 19 259/260	42x526.7	10	ROR
212 19 263/264	42x463.2	10	ROR
212 19 269/270	42x304.5	10	ROR
212 19 271/272	42x344.1	10	ROR
212 19 275/276	42x407.5	10	ROR
212 19 277/278	42x673.5	10	ROR
212 19 279/280	42x634	10	ROR
212 19 281/282	42x493.3	10	ROR
212 19 283/284	42x615	10	ROR
212 20 815/816	42x621.5	10	ROR
212 21 070/071	42x572	10	ROR
212 21 194/195	42X634	10	ROR
212 22 386/387	42x615	10	ROR
212 19 287/288	42X278.9	10	ROR
212 19 301/302	42X239.5	10	ROR
212 19 303/304	42X260	10	ROR
212 19 305/306	42X683.5	10	ROR
212 19 307/308	42X652.5	10	ROR
212 19 309/310	42X656.5	10	ROR

Original No.	DxL(mm)	Spline	Application
212 19 311/312	42X572	10	ROR
212 19 313/314	42X621.5	10	ROR
212 19 315/316	42X239.5	10	ROR
212 19 317/318	42X295.5	10	ROR
212 19 319/320	42X463.2	10	ROR
212 19 321/322	42X656.5	10	ROR
212 19 323/324	42X717	10	ROR
212 19 327/328	42X415.1	10	ROR
212 19 329/330	42X738.5	10	ROR
212 19 333/334	42X730.6	10	ROR
212 19 335/336	42X572	10	ROR
212 19 337/338	42X656.5	10	ROR
212 19 341/342	42x220.5	10	ROR
212 19 343/344	42x738.5	10	ROR
212 19 345/346	42X683.5	10	ROR
212 19 737/738	42X463.2	10	ROR
212 19 739/740	42X239.5	10	ROR
212 19 815/816	42X621.5	10	ROR
212 22 183/184	42X463.2	10	ROR
212 22 185/186	42X526.7	10	ROR
212 22 187/188	42X656.5	10	ROR
212 22 189/190	42X673.5	10	ROR
212 22 191/192	42X683.5	10	ROR
212 22 700/701	42X595.5	10	ROR
212 22 949/950	42X304.5	10	ROR
212 23 154/155	42X278.9	10	ROR
212 02 754/755	42X572	10	ROR
212 10 965/966	42X526.7	10	ROR
212 10 969/970	42X463.2	10	ROR
212 10 975/976	42X304.5	10	ROR
212 10 977/978	42X344.1	10	ROR
212 10 981/982	42X407.5	10	ROR
212 10 983/984	42X673.5	10	ROR
212 10 985/986	42X634	10	ROR
212 10 987/988	42X493.3	10	ROR
212 10 989/990	42X615	10	ROR
212 12 328/329	42X278.9	10	ROR

Original No.	DxL(mm)	Spline	Application
212 12 642/643	42X239.5	10	ROR
212 14 243/244	42X260	10	ROR
212 15 333/334	42X683.5	10	ROR
212 17 167/168	42X652.5	10	ROR
212 19 159/160	42X656.5	10	ROR
212 09 702/703	42X572	10	ROR
212 10 959/960	42X621.5	10	ROR
212 11 746/747	42X239.5	10	ROR
212 11 752/753	42X295.5	10	ROR
212 11 943/944	42X463.2	10	ROR
212 12 346/347	42X656.5	10	ROR
212 14 723/724	42X717	10	ROR
212 12 314/315	42X415.1	10	ROR
212 14 721/722	42X738.5	10	ROR
212 18 743/744	42X730.6	10	ROR
212 12 308/309	42X572	10	ROR
212 12 310/311	42X463.2	10	ROR
212 12 318/319	42X656.5	10	ROR
212 12 322/323	42X239.5	10	ROR
212 12 324/325	42X220.5	10	ROR
212 18 821/822	42X738.5	10	ROR
212 19 058/059	42X683.5	10	ROR
212 20 833/834	42X621.5	10	ROR

SAF SERIES:

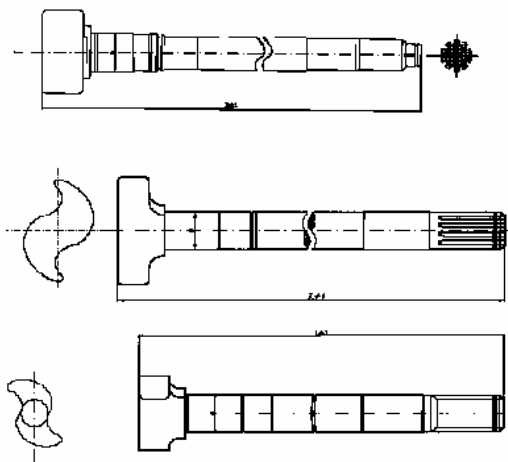

Original No.	DxL(mm)	Spline	Application
2.262.1103.01/1102.01	56x719	10	SAF
2.262.1103.02/1102.02	45x719	10	SAF
2.262.1106.02/1107.02	45x592	10	SAF
2.262.0258.01/0259.01	38x460	10	SAF
2.262.0253.02/0254.02	38x575.2	10	SAF
2.262.0261.02/0262.02	38x548	10	SAF
2.262.0263.02/0264.02	38x642	10	SAF
2.262.0265.02/0266.02	38x652	10	SAF
2.262.0269.02/0270.02	38x668.4	10	SAF
2.262.0271.02/0272.02	38x678	10	SAF
2.262.0283.02/0284.02	38x704	10	SAF
2.262.0285.02/0286.02	38x634	10	SAF
2.262.0293.02/0294.02	38x738	10	SAF
2.262.0317.02/0318.02	38x247	10	SAF
2.262.0403.02/0404.02	38x569.5	10	SAF
2.262.0405.02/0406.02	38x486.5	10	SAF
2.262.0411.02/0412.02	38x679.5	10	SAF
2.262.0415.02/0416.02	38x622.5	10	SAF
2262 110 901/801	56x669	10	SAF
2262 110 902/802	45x669	10	SAF
3.262.025.301/401	38x575	10	SAF
3.262.027.101/201	38x678	10	SAF
3.262.028.301/401	38x704	10	SAF
3.262.028.501/601	38x634	10	SAF
3.262.011.201/301	56x719	10	SAF

MAN SERIES:

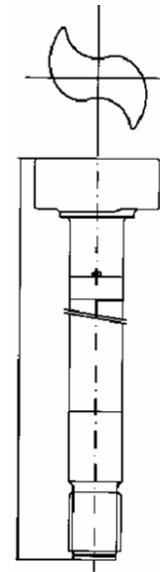

Original No.	DxL(mm)	Spline	Application
62 344 210 136/236	42X242	26	MAN
81 503 010 223/224	42x255	26	MAN
81 503 010 112/113	42X545	26	MAN
81 503 010 225/226	42X226	26	MAN

BENZ SERIES:

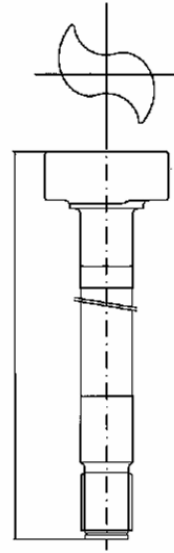

Original No.	DxL(mm)	Spline	Application
335 421 03 36/04 36	42x242	26	BENZ
623 421 01 36/02 36	42x255	26	BENZ
623 423 01 36/02 36	42x545	26	BENZ

YORK SERIES:

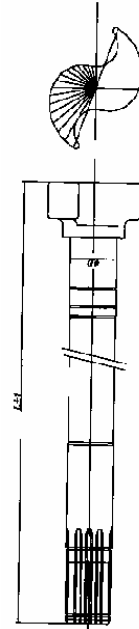

Original No.	DxL(mm)	Spline	Application
Y5047 42-01L/R	38x580	10	YORK
Y5047 42-02L/R	38x658	10	YORK
Y5047 42-19L/R	38x670	10	YORK
Y5047 23-01L/R	38x580	10	YORK
Y5047 23-10L/R	38x726	10	YORK
Y5047 23-17L/R	38x675	10	YORK
Y5047 23-18L/R	38x684	10	YORK

TRAILOR & FRUEHAUF SAERIES:

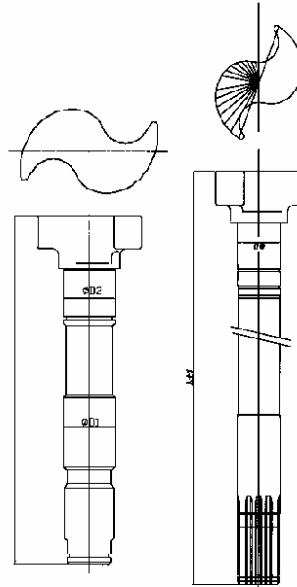

Original No.	DxL(mm)	Spline	Application
7000081L/82M	38x629	10	TRAILOR
6503390L/91M	38x635	10	TRAILOR
202100236L/236R	38x649	10	TRAILOR
A-JA-0476-003/004	42x593	37	FRUEHAUF
A-JA-0660-003/004	42x637	37	FRUEHAUF
A-XA-000420-001/002	40.38x464	37	FRUEHAUF
A-XA-000420-003/004	40.38x591	37	FRUEHAUF

AMERICA SERIES:

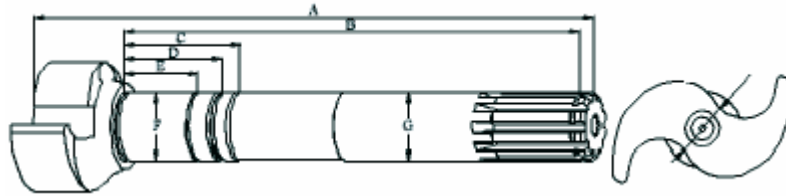



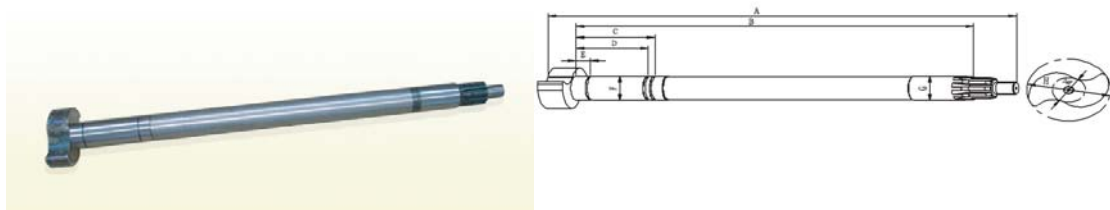

Original No.	DxL(mm)	Spline	Application
M16WK104-25/105-25	38x651	28	SPICER
M16WK104-17/105-17	38x571.5	28	SPICER
M16WKL25-236/M16WKR25-236	38x651	28	SPICER
R607075/76	38x345	10	MERITOR
R607091/92	38x270.5	10	MERITOR
R607069/70	38x572	10	MERITOR
2210C6867/B6866	38x495	28	MERITOR
2210E6869/D6868	38x666	28	MERITOR
2210A7099/H7522	38x337	28	MERITOR
2210T8158/S8157	41.14x572	28	MERITOR
2210R8156/Q8155	38x494	28	MERITOR
2210V8160/U8159	38x664	28	MERITOR
2210A6995/B7594	38x390	28	MERITOR
2210A6943/V7536	38x349	28	MERITOR
2210Q7427/P7426	38x274	28	MERITOR

EUROPE SERIES:



OE No.	Application
05.097.05.27.0/05.097.05.28.0	BPW
05.097.05.55.0/05.097.05.56.0	BPW
05.097.05.57.0/05.097.05.58.0	BPW

S-Camshaft Repair Kits:

	OE No.	Application
	A9883	BPW Old
	OE No.	Application
	09.801.06.09.0	BPW Old
	OE No.	Application
	09.801.02.22.0	BPW New
	OE No.	Application
	A8258	TRAILER
	OE No.	Application
	A5885-1	FRUEHAUF